

User Manual

7003 Smart Door Lock

Product Layout:

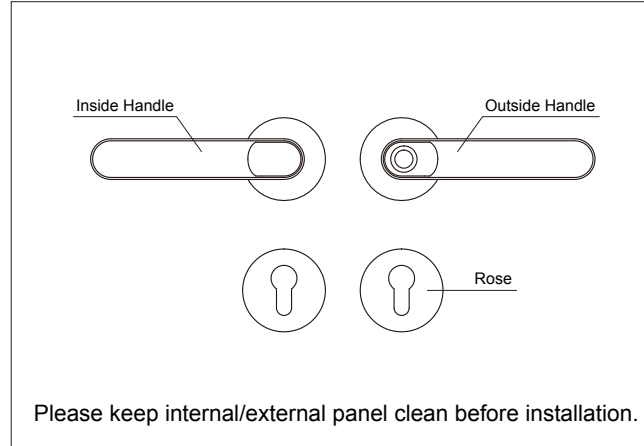

Handle change direction

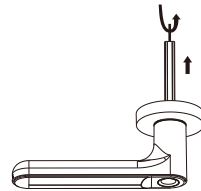

Pull spindle out and turn 180 degree

Lock body change direction

Latch adjust parts Commutate

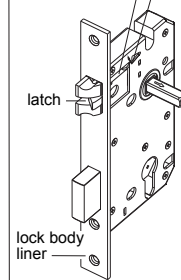

1. When installing lock sure latch bolt should always on top and dead bolt at.
2. Please adjust latch bolt slope when necessary.
 - a. Latch bolt commutator follow arrow direction that push latch bolt in adjust it as required.
 - b. Turn latch bolt 180° and take it out from liner after adjusting.

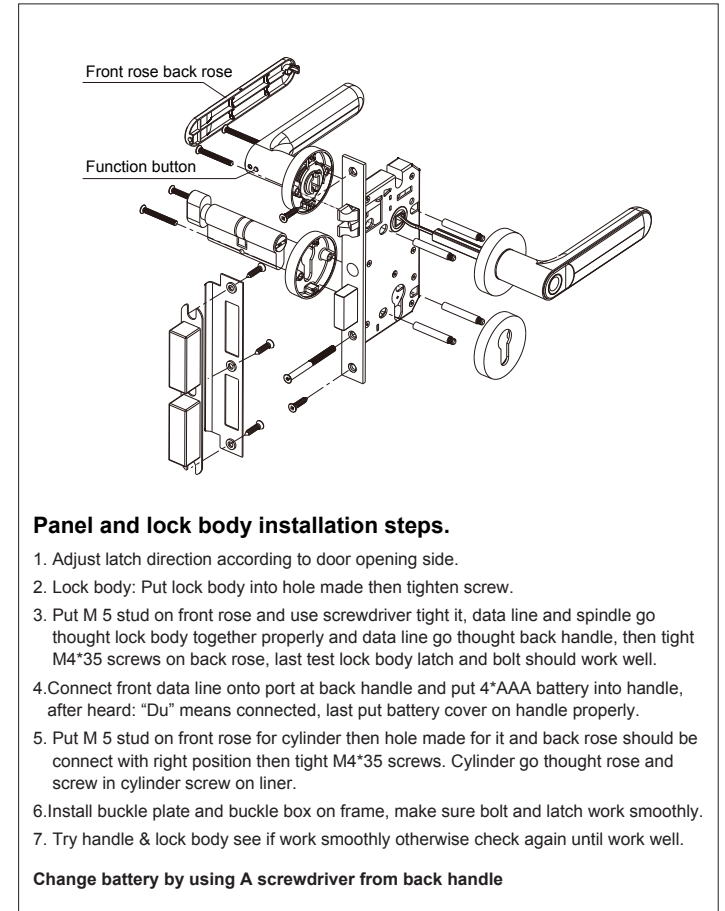

Product Features:

- Multiple way to access: Fingerprint & Mechanical Key.
- Fingerprint: Advanced semiconductor sensors with 360° scanner.
- Lock can have fingerprint access users capacity: Fingerprint (2 master users & 28 normal users).
- Reminder: Unlock, low battery and up to lock voice.
- External power supply: Can use power bank with 5V for emergency power supply.

Remark:

1. After installation of lock please reset lock to factory default mode.
2. After factory default mode make sure to register 1 master user.
3. The handle is the key part for opening and closing door, and its flexibility ratio directly influences the usage of door lock, hence, don't hang articles on handle.
4. Gently press fingerprint on the fingerprint sensor for registration of fingerprint.
Please don't press with great force to prevent scratching the fingerprint sensor.
5. This lock uses 4 AAA high-energy alkaline batteries (1.5V). When it prompts "the voltage is low, please replace battery" for the first time, the door can be opened for about 100 times as per different battery capacities; At this time, the battery should be replaced promptly to avoid inconvenience due to the exhausted battery.

Operations:

1. **Reset factory default:** Press function button at back of lock for 5 seconds, voice will prompt reset succeed.
2. **Register master/user:**
 - 2.1 **Initial mode:** Short press function button at back handle 1 time voice promote add master.
 - 2.2 **Once master user is added:** Short press function button at back handle 1 time, input any registered master at this time can add 1 more master(if only 1 master registered) or common user.
3. **Delete registered fingerprint:**
 - 3.1 Short press function button at back handle 3 time, confirm any registered master and input master or user need to be deleted, until heard succeed.

Other function:

1. **Internal Forced Lock:** Short press function button 2 times, voice promote locking, at this time only master and key can unlock
2. **On/Off unlocking mode:**
 - 2.1 After master open and pres function button at back 1 time within 6 second,unlocking mode on.
 - 2.2 By using mater open 1 time unlocking mode will off.
3. **Turn off voice:** Short press function button at back for 4 times, voice promote will be off.
4. **Electricity quantity Checking and series checking:** Short press function button at back for 5 times, voice will promote (low / medium/high battery) and series no.

Remark:

1. All fingerprint need to scan 3 times for addition.
2. After successful registration press function button at back to exit.
3. When Deleting fingerprint, one master user in fingerprint has to be left.

How to take battery cover out:

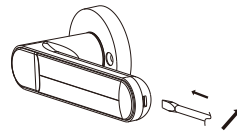

When change battery use slotted screwdriver push in and up towards door direction.